

# Rollout Maxy

RETRACTABLE SYSTEM

NEW



Supply options



# ROLLOUT MAXY WITH MAGNETS

- 1 08-00120-xx Rollout MAXY case
- 2 08-10100-45 Polypropilene mesh on the tube 5000x1220
- 2.1 08-10110-45 Polypropilene mesh on the tube 5000x1420
- 2.2 08-10120-45 Polypropilene mesh on the tube 5000x1820
- 22 08-00000-05 Setting plate for polypropilene mesh L.2600
- 3 08-00140-xx Rollout MAXY sliding bar
- 4 08-00070-xx Rollout cover profile for magnet
- 5 08-00160-xx Rollout MAXY «U» profile
- 6 08-00150-xx Rollout MAXY top guide
- 7 08-13350-05 Maxy top guide cap («U» profile side)
- 8 08-13340-05 Maxy top guide cap (case side)
- 9 00-02400-05 Pile 4,8x13
- 10 08-13330-05 Cap for top endcap for Maxy sliding bar
- 11 00-13180-00 Tapping screw 3x10
- 12 08-16001-05 Magnet positive Rollout
- 13 08-16011-05 Magnet negative Rollout
- 14 08-13300-05 Top endcap for Maxy sliding bar
- 15 08-13290-05 Bottom endcap for Maxy sliding bar
- 16 08-13310-05 Upper scorpion tail MAXY
- 17 08-13060-05 Lower scorpion tail MAXY
- 18 08-13280-05 Top endcap for MAXY case
- 19 08-13270-05 Maxy bushing
- 20 08-13260-05 Maxy complete endcap with spring
- 21 05-13000-05 Wire CB-40051
- 22 08-13070-03 Ballast holder
- 23 08-13080-00 Steel ballast
- 24 00-13710-00 Screw 3x4
- 25 05-13110-05 Clip
- 26 08-13010-05 Plate with 2 hole M3
- 27 08-00170-05 Maxy «T» shape PVC bottom rail L.2600
- 28 05-00140-00 PVC 6° slope bottom rail L.2600
- 29 08-13050-05 Tail slide DT
- 30 08-13320-05 Maxy white tail end

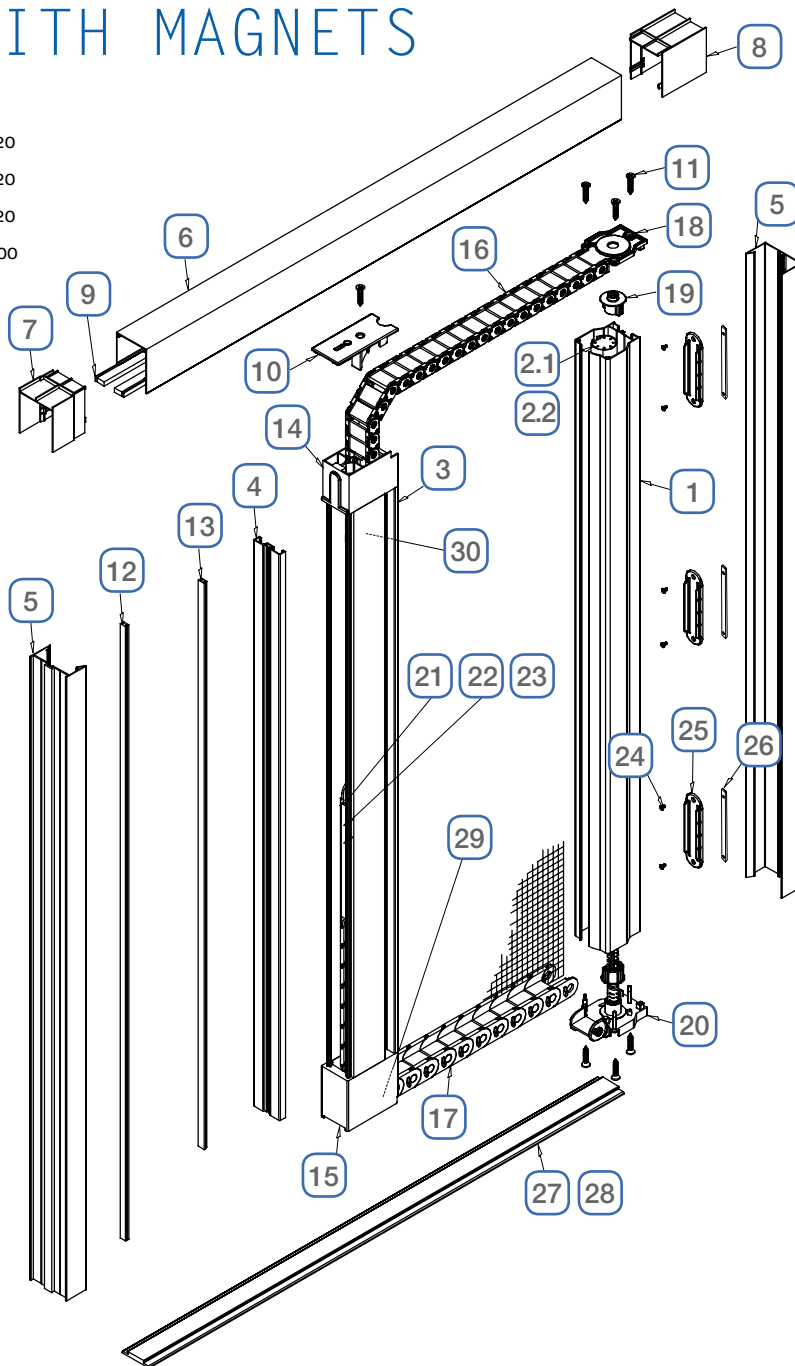

## Opening options

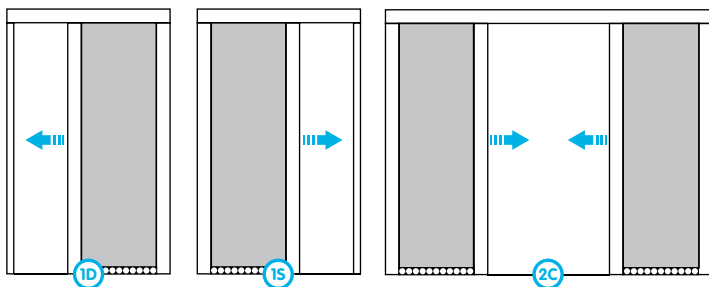

## Profiles sections

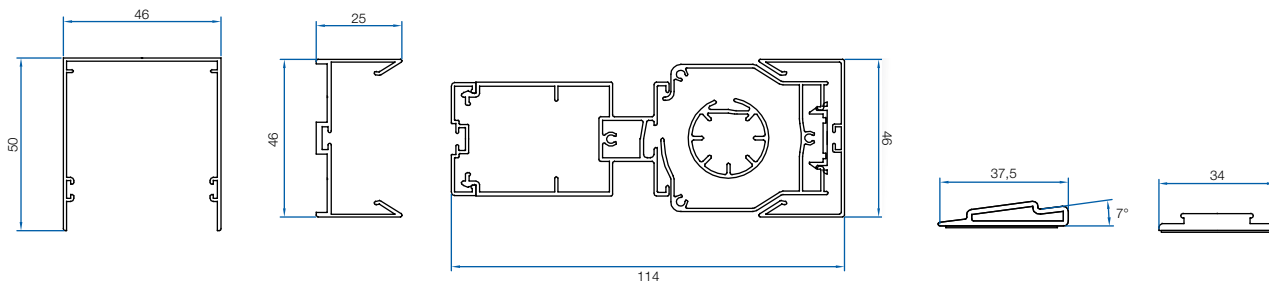

- A** 08-13230-05 Top guide stopper for Rollout double
- B** 08-13250-05 Latch top device for Rollout double
- C** 08-13220-05 Latch bottom device for Rollout double
- D** 00-13590-00 Screw 3,5x16
- E** 00-13180-00 Screw 2,8x9

*\* Additional references for Rollout Maxy double horizontal*

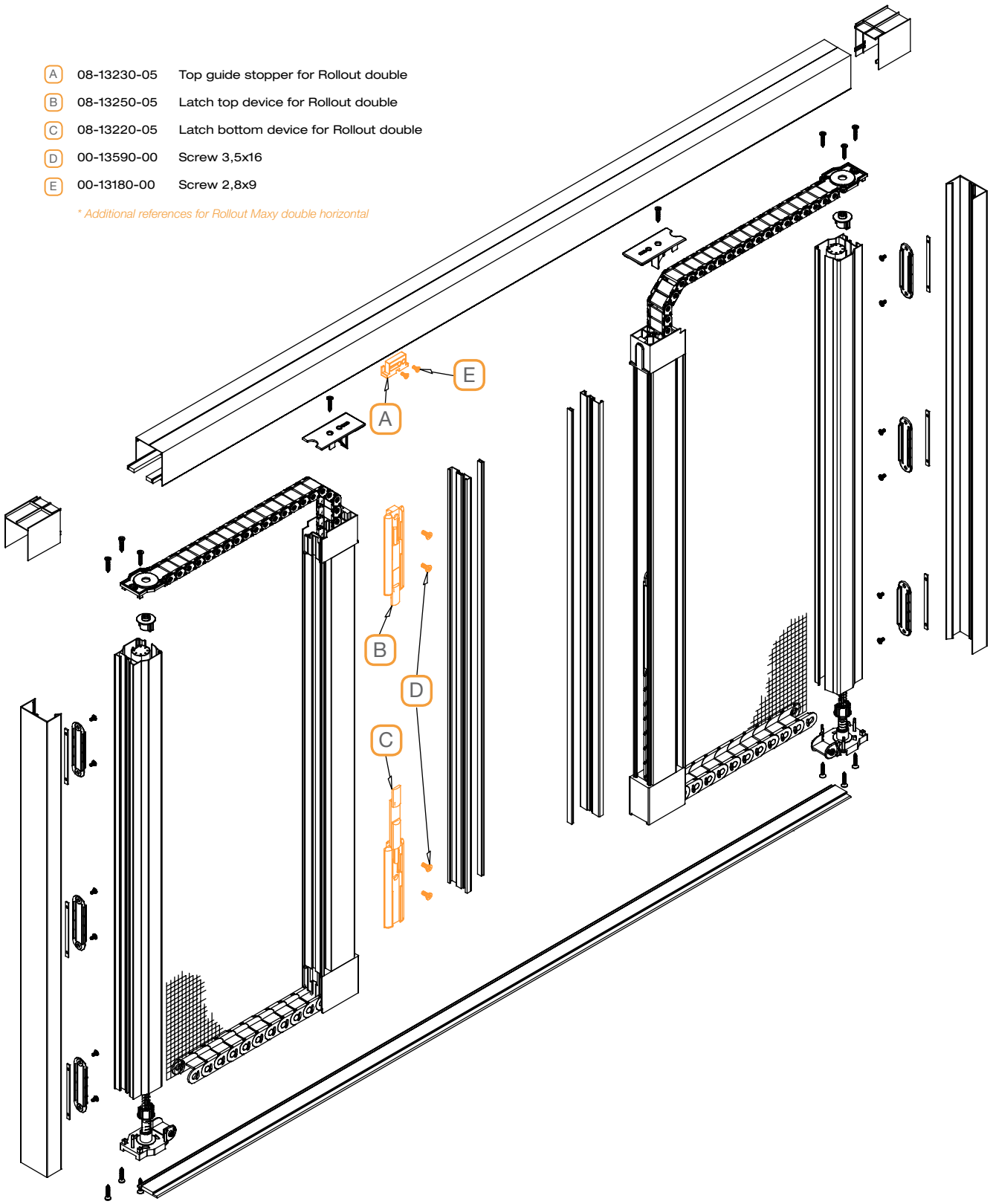

# ROLLOUT MAXY WITH LATCH

- A** 08-00100-xx «U» profile for latch
- B** 08-00090-xx Cover profile for latch
- C** 08-13130-05 Latch
- D** 08-13190-05 Latch hanger RSZ
- E** 08-13140-05 Slide pulley

\* Special references for Rollout Maxy with latch

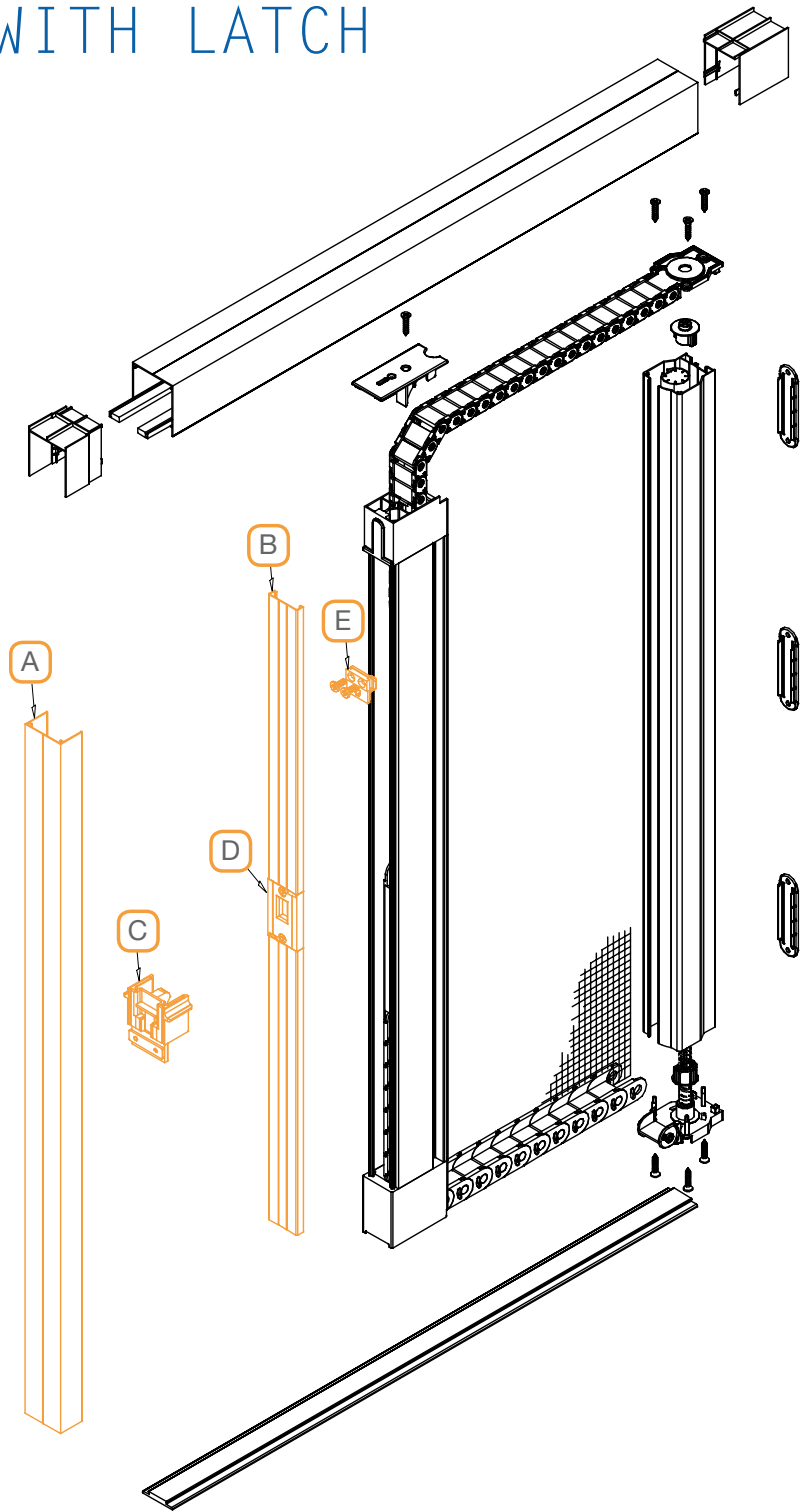

## Opening options

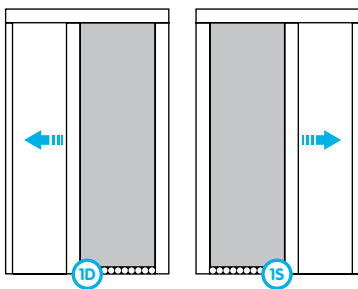

## Profiles sections

